

New Residential Commons Complex

The new Residential Commons complex will provide an integrated academic and residential experience to 1,250 students. The complex is composed of five residence buildings, a dining commons and a parking center.

The facilities are part of a larger SMU initiative to enhance students' living-and-learning experience and enable all first-year students and sophomores to live on campus. Faculty members, some with their families, also will live in the Commons and have offices and teach in on-site classrooms.



Armstrong Commons



Anita and Truman Arnold Dining Commons

The model supports a strong residential community, one enabling students to make friends more easily, transition more smoothly to campus life, enhance personal exploration and growth and benefit from new leadership opportunities. The model also promotes a sense of identity and belonging. Each Commons will develop traditions and host gatherings and activities to create a sense of community among residents.



Kathy Crow Commons



Crum Commons

The new Residential Commons complex is located prominently in the southeast quadrant of campus adjacent to Ford Stadium and Dedman Center for Lifetime Sports. The facilities also feature common areas and program space. The Dining Commons will be shared by all residents of the Commons and open to the campus community.



Loyd Commons



Ware Commons

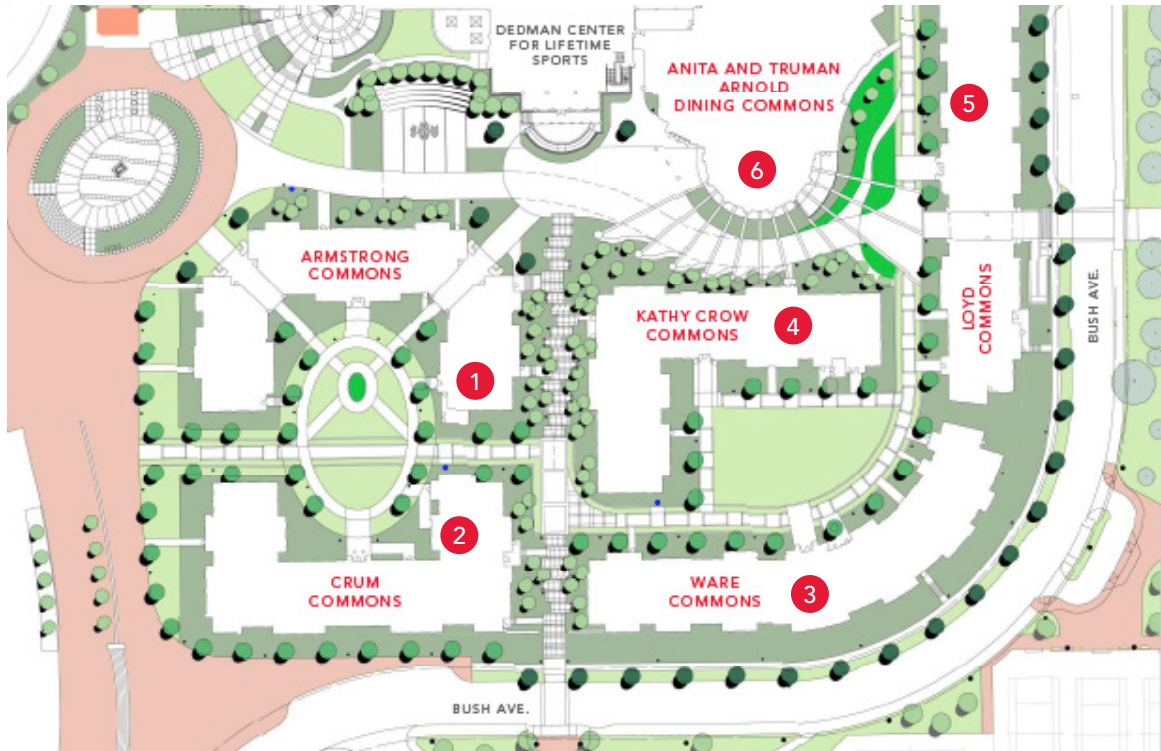

- 1 Armstrong Commons
- 2 Crum Commons
- 3 Ware Commons
- 4 Kathy Crow Commons
- 5 Loyd Commons
- 6 Anita and Truman Arnold Dining Commons